

Nippli di riduzione di filetto

Filetti: gas x gas
Tenuta a forma B-DIN 3852, spigolo metallico

Male/female reducing adaptors

Threads: B.S.P. x B.S.P. parallel
Stud sealing form B-DIN, sealing shoulder

Gewindereduzierungen

Gewinde: Whitworth-rohr x Whitworth-rohr
Abdichtart Form B-DIN, durch Dichtkant

Réductions filetées mâles/femelles

Filetage: whitworth x whitworth
Arête d'étanchéité forme B-DIN, métal-métal

Adaptadores de reducción macho/hembra

Rosca: gas x gas
Estanqueidad forma B-DIN, canto torneado metálico

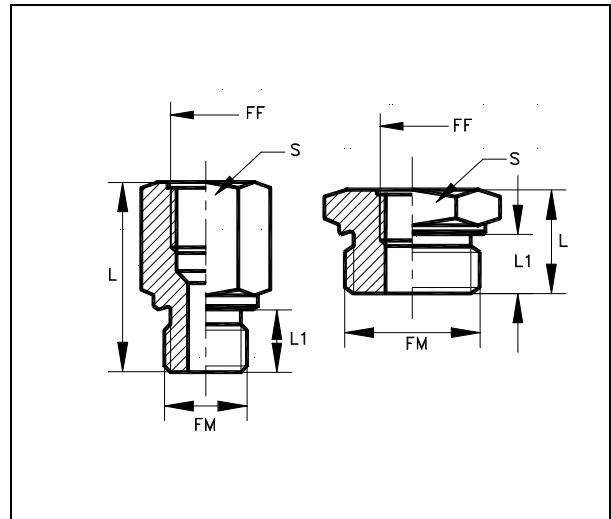

FM	FF	L	L1	S		TAA
R 1/8"	R 3/8"	32	8	24	T-RI 1/8"-3/8"	17000011 A
	R 1/4"	32		19	T-RI 1/8"-1/4"	17000111 A
R 1/4"	R 3/4"	43	12	36	T-RI 1/4"-3/4"	17000211 A
	R 1/2"	40		27	T-RI 1/4"-1/2"	17000311 A
	R 3/8"	36		24	T-RI 1/4"-3/8"	17000411 A
	R 1/8"	28		19	T-RI 1/4"-1/8"	17000511 A
R 3/8"	R 3/4"	44	12	36	T-RI 3/8"-3/4"	17000611 A
	R 1/2"	41		27	T-RI 3/8"-1/2"	17000711 A
	R 1/4"	36		22	T-RI 3/8"-1/4"	17000811 A
	R 1/8"	22		22	T-RI 3/8"-1/8"	17000911 B
R 1/2"	R 1"1/4"	53	14	55	T-RI 1/2"-1"1/4"	17001011 A
	R 1"	49		41	T-RI 1/2"-1"	17001111 A
	R 3/4"	46		36	T-RI 1/2"-3/4"	17001211 A
	R 3/8"	36		27	T-RI 1/2"-3/8"	17001311 A
	R 1/4"	24		27	T-RI 1/2"-1/4"	17001411 B
	R 1/8"	24		27	T-RI 1/2"-1/8"	17001511 B

Nippli di riduzione di filetto

Filetti: gas x gas
Tenuta a forma B-DIN 3852, spigolo metallico

Male/female reducing adaptors

Threads: B.S.P. x B.S.P. parallel
Stud sealing form B-DIN, sealing shoulder

Gewindereduzierungen

Gewinde: Whitworth-rohr x Whitworth-rohr
Abdichtart Form B-DIN, durch Dichtkant

Réductions filetées mâles/femelles

Filetage: whitworth x whitworth
Arête d'étanchéité forme B-DIN, métal-métal

Adaptadores de reducción macho/hembra

Rosca: gas x gas
Estanqueidad forma B-DIN, canto torneado metálico

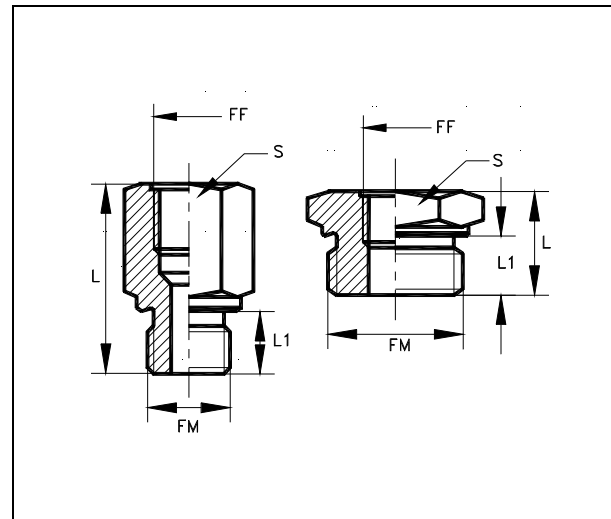

FM	FF	L	L1	S		TAA
R 3/4"	R 1"1/2	57	16	60	T-RI 3/4"-1"1/2	17001611 A
	R 1"1/4	55		55	T-RI 3/4"-1"1/4	17001711 A
	R 1"	51		41	T-RI 3/4"-1"	17001811 A
	R 1/2"	41		32	T-RI 3/4"-1/2"	17001911 A
	R 3/8"	26		32	T-RI 3/4"-3/8"	17002011 B
	R 1/4"	26		32	T-RI 3/4"-1/4"	17002111 B
R 1"	R 1"1/2	59	18	60	T-RI 1"-1"1/2	17002211 A
	R 1"1/4	57		55	T-RI 1"-1"1/4	17002311 A
	R 3/4"	47		41	T-RI 1"-3/4"	17002411 A
	R 1/2"	29		41	T-RI 1"-1/2"	17002511 B
	R 3/8"	29		41	T-RI 1"-3/8"	17002611 B
	R 1/4"	29		41	T-RI 1"-1/4"	17002711 B
R 1"1/4	R 1"1/2	60	20	60	T-RI 1"1/4-1"1/2	17002811 A
	R 1"	52		50	T-RI 1"1/4-1"	17002911 A
	R 3/4"	32		50	T-RI 1"1/4-3/4"	17003011 B
	R 1/2"	32		50	T-RI 1"1/4-1/2"	17003111 B
R 1"1/2	R 1"1/4	58	22	55	T-RI 1/2"-1"1/4	17003211 A
	R 1"	36		55	T-RI 1/2"-1"	17003311 B
	R 3/4"	36		55	T-RI 1/2"-3/4"	17003411 B
	R 1/2"	36		55	T-RI 1/2"-1/2"	17003511 B

Nippli di riduzione di filetto

Filetti: metrico x metrico
Tenuta a forma B-DIN 3852, spigolo metallico

Male/female reducing adaptors

Threads: metric x metric
Stud sealing form B-DIN 3852, sealing shoulder

Gewindereduzierungen

Gewinde: metrisch-fein x metrisch-fein
Abdichtart Form B-DIN, durch Dichtkante

Réductions filetées mâles/femelles

Filetage: métrique x métrique
Arête d'étanchéité forme B-DIN, métal-métal

Adaptadores de reducción macho/hembra

Rosca: métrica x métrica
Estanquedad forma B-DIN, canto torneado metálico

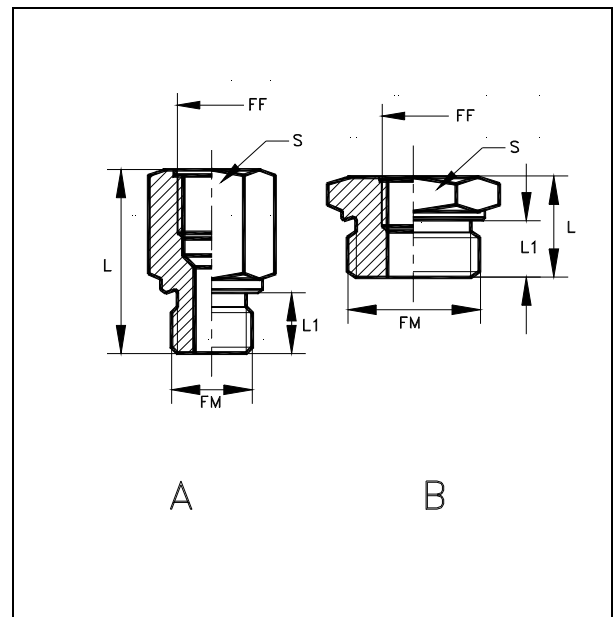

FM	FF	L	L1	S		TAA
M 10x1	M12x1.5	30	8	17	T-RI M10x1 –M12x1.5	17400011 A
	M14x1.5	32		19	T-RI M10x1 –M14x1.5	17400111 A
M 12x1.5	M10x1.5	28	12	17	T-RI M12x1.5-M10x1.5	17400211 A
	M12x1.5	36		19	T-RI M12x1.5-M12x1.5	17400311 A
	M14x1.5	36		22	T-RI M12x1.5-M14x1.5	17400411 A
	M16x1.5	36		24	T-RI M12x1.5-M16x1.5	17405011 A
	M22x1.5	36		30	T-RI M12x1.5-M22x1.5	17400511 A
M 14x1.5	M12x1.5	36	12	19	T-RI M14x1.5-M12x1.5	17400611 A
	M16x1.5	36		24	T-RI M14x1.5-M16x1.5	17400711 A
	M18x1.5	36		27	T-RI M14x1.5-M18x1.5	17400811 A
	M20x1.5	40		27	T-RI M14x1.5-M20x1.5	17400911 A
	M22x1.5	40		27	T-RI M14x1.5-M22x1.5	17405111 A
M 16x1.5	M10x1	36	12	22	T-RI M16x1.5-M10x1	17405211 A
	M12x1.5	36		22	T-RI M16x1.5-M12x1.5	17401011 A
	M14x1.5	36		22	T-RI M16x1.5-M14x1.5	17401111 A
	M18x1.5	36		27	T-RI M16x1.5-M18x1.5	17401211 A
	M20x1.5	40		27	T-RI M16x1.5-M20x1.5	17401311 A
	M22x1.5	40		30	T-RI M16x1.5-M22x1.5	17401411 A
M 18x1.5	M12x1.5	36	12	24	T-RI M18x1.5-M12x1.5	17401511 A
	M14x1.5	36		24	T-RI M18x1.5-M14x1.5	17401611 A
	M16x1.5	36		24	T-RI M18x1.5-M16x1.5	17401711 A
	M20x1.5	40		27	T-RI M18x1.5-M20x1.5	17401811 A
	M22x1.5	40		30	T-RI M18x1.5-M22x1.5	17401911 A

Nippli di riduzione di filetto

Filetti: metrico x metrico
Tenuta a forma B-DIN 3852, spigolo metallico

Male/female reducing adaptors

Threads: metric x metric
Stud sealing form B-DIN 3852, sealing shoulder

Gewindereduzierungen

Gewinde: metrisch-fein x metrisch-fein
Abdichtart Form B-DIN, durch Dichtkante

Réductions filetées mâles/femelles

Filetage: métrique x métrique
Arête d'étanchéité forme B-DIN, métal-métal

Adaptadores de reducción macho/hembra

Rosca: métrica x métrica
Estanqueidad forma B-DIN, canto torneado metálico

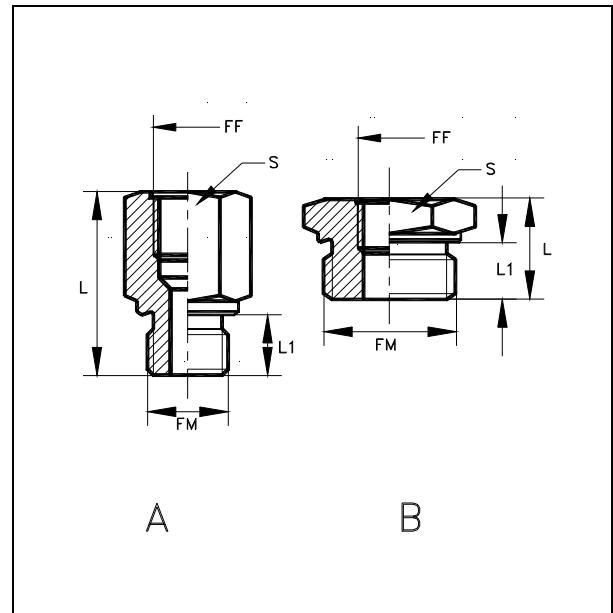

FM	FF	L	L1	S		TAA
M 20x1.5	M12x1.5	24	14	27	T-RI M20x1.5-M12x1.5	17402011 B
	M14x1.5	38		27	T-RI M20x1.5-M14x1.5	17402111 A
	M16x1.5	38		27	T-RI M20x1.5-M16x1.5	17402211 A
	M18x1.5	38		27	T-RI M20x1.5-M18x1.5	17402311 A
	M22x1.5	40		30	T-RI M20x1.5-M22x1.5	17402411 A
	M26x1.5	46		36	T-RI M20x1.5-M26x1.5	17402511 A
	M30x1.5	49		41	T-RI M20x1.5-M30x1.5	17402611 A
M 22x1.5	M10x1	24	14	27	T-RI M22x1.5-M10x1	17402711 B
	M12x1.5	24		27	T-RI M22x1.5-M12x1.5	17402811 B
	M14x1.5	24		27	T-RI M22x1.5-M14x1.5	17402911 B
	M16x1.5	38		27	T-RI M22x1.5-M16x1.5	17403011 A
	M18x1.5	38		27	T-RI M22x1.5-M18x1.5	17403111 A
	M20x1.5	40		27	T-RI M22x1.5-M20x1.5	17403211 A
	M26x1.5	46		36	T-RI M22x1.5-M26x1.5	17403311 A
M 24x1.5	M20x1.5	42	16	30	T-RI M24x1.5-M20x1.5	17404011 A
	M30x1.5	51		36	T-RI M24x1.5-M30x1.5	17404111 A
M 26x1.5	M12x1.5	26	16	32	T-RI M26x1.5-M12x1.5	17404511 B
	M22x1.5	42		32	T-RI M26x1.5-M22x1.5	17404611 A
	M18x1.5	40		32	T-RI M26x1.5-M18x1.5	17404711 A
M 28x1.5	M20x1.5	42	16	36	T-RI M28x1.5-M20x1.5	17404811 A
	M22x1.5	42		36	T-RI M28x1.5-M22x1.5	17404911 A

Nippli di riduzione di filetto

Filetti: gas x metrico
Tenuta a forma B-DIN 3852, spigolo metallico

Male/female reducing adaptors

Threads: B.S.P. parallel x metric
Stud sealing form B-DIN 3852, sealing shoulder

Gewindereduzierungen

Gewinde: whitworth-rohr x metrisch-fein
Abdichtart Form B-DIN, durch Dichtkante

Réductions filetées mâles/femelles

Filetage: whitworth x métrique
Arête d'étanchéité forme B-DIN, métal-métal

Adaptadores de reducción macho/hembra

Rosca: gas x métrica
Estanqueidad forma B-DIN, canto torneado metálico

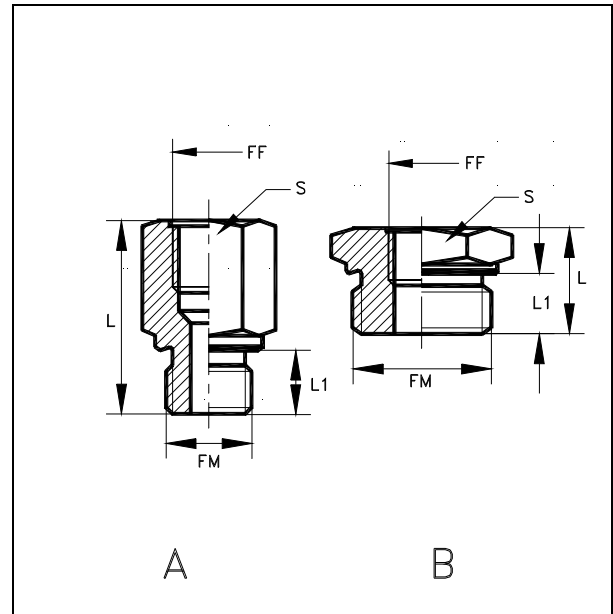

FM	FF	L	L1	S		taa
R 1/8"	M12x1.5	30	8	19	T-RI 1/8"-M12x1.5	17100011 A
	M14x1.5	32		22	T-RI 1/8"-M14x1.5	17100111 A
R 1/4"	M12x1.5	36	12	19	T-RI 1/4"-M12x1.5	17100211 A
	M14x1.5	36		19	T-RI 1/4"-M14x1.5	17100311 A
	M16x1.5	36		24	T-RI 1/4"-M16x1.5	17100411 A
	M18x1.5	36		27	T-RI 1/4"-M18x1.5	17100511 A
	M20x1.5	40		27	T-RI 1/4"-M20x1.5	17100611 A
	M22x1.5	40		30	T-RI 1/4"-M22x1.5	17100711 A
R 3/8"	M14x1.5	36	12	22	T-RI 3/8"-M14x1.5	17100811 A
	M16x1.5	36		24	T-RI 3/8"-M16x1.5	17100911 A
	M18x1.5	36		27	T-RI 3/8"-M18x1.5	17101011 A
	M20x1.5	40		27	T-RI 3/8"-M20x1.5	17101111 A
	M22x1.5	40		30	T-RI 3/8"-M22x1.5	17101211 A
R 1/2"	M16x1.5	38	14	27	T-RI 1/2"-M16x1.5	17101311 A
	M18x1.5	38		27	T-RI 1/2"-M18x1.5	17101411 A
	M20x1.5	40		27	T-RI 1/2"-M20x1.5	17101511 A
	M22x1.5	40		30	T-RI 1/2"-M22x1.5	17101611 A
	M26x1.5	46		36	T-RI 1/2"-M26x1.5	17101711 A

Nippli di riduzione di filetto

Filetti: gas x metrico
Tenuta a forma B-DIN 3852, spigolo metallico

Male/female reducing adaptors

Threads: B.S.P. parallel x metric
Stud sealing form B-DIN 3852, sealing shoulder

Gewindereduzierungen

Gewinde: whitworth-rohr x metrisch-fein
Abdichtart Form B-DIN, durch Dichtkante

Réductions filetées mâles/femelles

Filetage: whitworth x métrique
Arête d'étanchéité forme B-DIN, métal-métal

Adaptadores de reducción macho/hembra

Rosca: gas x métrica
Estanqueidad forma B-DIN, canto torneado metálico

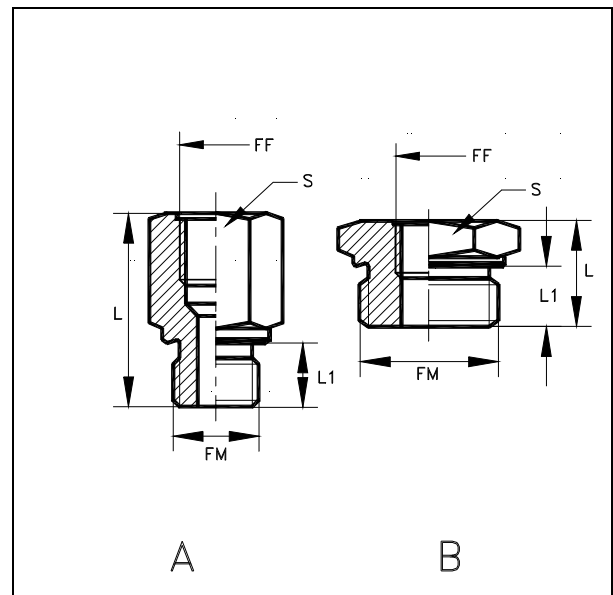

FM	FF	L	L1	S		taa
R 3/4"	M18x1.5	26	16	32	T-RI 3/4"-M18x1.5	17101811 B
	M20x1.5	41		32	T-RI 3/4"-M20x1.5	17101911 A
	M22x1.5	41		32	T-RI 3/4"-M22x1.5	17102011 A
	M26x1.5	46		36	T-RI 3/4"-M26x1.5	17102111 A
	M30x1.5	51		41	T-RI 3/4"-M30x1.5	17102211 A
R 1"	M22x1.5	29	18	41	T-RI 1"-M22x1.5	17102311 B
	M26x1.5	47		41	T-RI 1"-M26x1.5	17102411 A
	M30x1.5	52		41	T-RI 1"-M30x1.5	17102511 A
	M33x2	52		41	T-RI 1"-M33x2	17102611 A
R 1"1/4	M22x1.5	32	20	50	T-RI 1"1/4-M22x1.5	17102711 B
	M26x1.5	32		50	T-RI 1"1/4-M26x1.5	17102811 B
	M30x1.5	58		50	T-RI 1"1/4-M30x1.5	17102911 A
	M33x2	52		50	T-RI 1"1/4-M33x2	17103011 A
	M42x2	60		55	T-RI 1"1/4-M42x2	17103111 A
R 1"1/2	M22x1.5	36	22	55	T-RI 1"1/2-M22x1.5	17103211 B
	M26x1.5	36		55	T-RI 1"1/2-M26x1.5	17103311 B
	M30x1.5	36		55	T-RI 1"1/2-M30x1.5	17103411 B
	M33x2	36		55	T-RI 1"1/2-M33x2	17103511 B
	M42x2	62		55	T-RI 1"1/2-M42x2	17103611 A

Nippli di riduzione di filetto

Filetti: metrico x gas
Tenuta a forma B-DIN 3852, spigolo metallico

Male/female reducing adaptors

Threads: metric x B.S.P. parallel
Stud sealing form B-DIN, sealing shoulder

Gewindereduzierungen

Gewinde: metrisch-fein x Whitworth-Rohr
Abdichtart Form B-DIN, durch Dichtkante

Réductions filetées mâles/femelles

Filetage: métrique x whitworth
Arête d'étanchéité forme B-DIN, métal-métal

Adaptadores de reducción macho/hembra

Rosca: métrica x gas
Estanqueidad forma B-DIN, canto torneado metálico

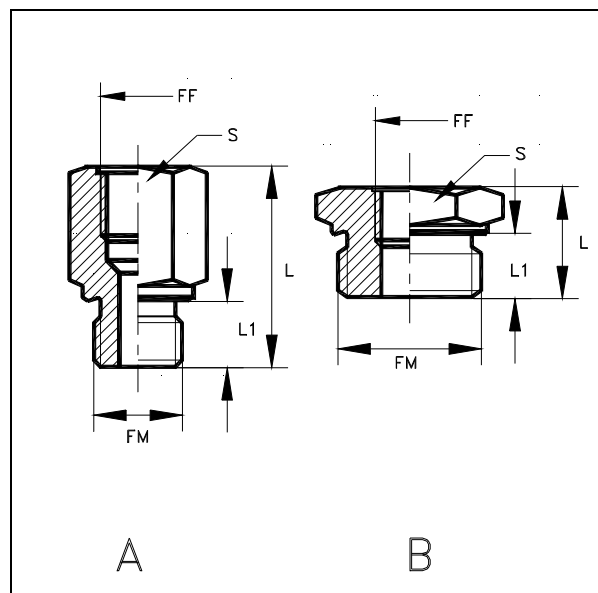

FM	FF	L	L1	S		TAA
M 10X1	R 1/8"	28	8	14	T-RI M10x1 -R1/8"	17500011 A
	R 1/4"	32		19	T-RI M10x1 -R1/4"	17500111 A
M 12X1.5	R 1/8"	28	12	17	T-RI M12x1.5-R1/8"	17500211 A
	R 1/4"	36		19	T-RI M12x1.5-R1/4"	17500311 A
	R 3/8"	36		24	T-RI M12x1.5-R3/8"	17500411 A
M 14X1.5	R 1/4"	36	12	19	T-RI M14x1.5-R1/4"	17500511 A
	R 3/8"	36		24	T-RI M14x1.5-R3/8"	17500611 A
	R 1/2"	40		27	T-RI M14x1.5-R1/2"	17500711 A
M 16x1.5	R 1/4"	36	12	22	T-RI M16x1.5-R1/4"	17500811 A
	R 3/8"	36		24	T-RI M16x1.5-R3/8"	17500911 A
	R 1/2"	41		27	T-RI M16x1.5-R1/2"	17501011 A
M 18X1.5	R 1/4"	36	12	24	T-RI M18x1.5-R1/4"	17501111 A
	R 3/8"	36		24	T-RI M18x1.5-R3/8"	17501211 A
	R 1/2"	41		27	T-RI M18x1.5-R1/2"	17501311 A
M 20X1.5	R 3/8"	36	14	27	T-RI M20x1.5-R3/8"	17501411 A
	R 1/2"	41		27	T-RI M20x1.5-R1/2"	17501511 A
	R 3/4"	46		32	T-RI M20x1.5-R3/4"	17501611 A
M 22X1.5	R 3/8"	41	14	27	T-RI M22x1.5-R3/8"	17501711 A
	R 1/2"	41		27	T-RI M22x1.5-R1/2"	17501811 A
	R 3/4"	46		32	T-RI M22x1.5-R3/4"	17501911 A

Nippli di riduzione di filetto

Filetti: metrico x gas
Tenuta a forma B-DIN 3852, spigolo metallico

Male/female reducing adaptors

Threads: metric x B.S.P. parallel
Stud sealing form B-DIN, sealing shoulder

Gewindereduzierungen

Gewinde: metrisch-fein x Whitworth-Rohr
Abdichtart Form B-DIN, durch Dichtkante

Réductions filetées mâles/femelles

Filetage: métrique x whitworth
Arête d'étanchéité forme B-DIN, métal-métal

Adaptadores de reducción macho/hembra

Rosca: métrica x gas
Estanqueidad forma B-DIN, canto torneado metálico

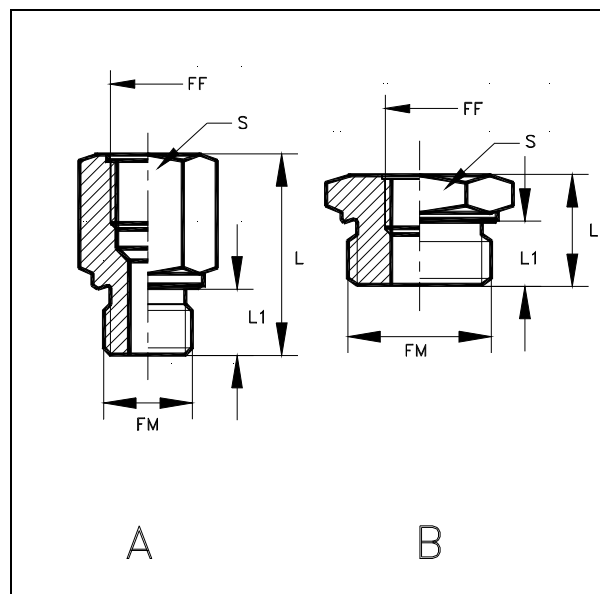

FM	FF	L	L1	S		TAA
M 26X1.5	R 1/2"	41	16	32	T-RI M26x1.5-R1/2"	17502011 A
	R 3/4"	48		32	T-RI M26x1.5-R3/4"	17502111 A
	R 1"	51		41	T-RI M26x1.5-R1"	17502211 A
M 30X1.5	R 1/2"	43	18	36	T-RI M30x1.5-R1/2"	17502311 A
	R 3/4"	48		36	T-RI M30x1.5-R3/4"	17502411 A
	R 1"	51		41	T-RI M30x1.5-R1"	17502511 A
M 33X2	R 1/2"	29	18	41	T-RI M33x2-R1/2"	17502611 B
	R 3/4"	47		41	T-RI M33x2-R3/4"	17502711 A
	R 1"	54		41	T-RI M33x2-R1"	17502811 A
M 36x2	R 3/4"	47	20	46	T-RI M36x2-R3/4"	17502911 A
	R 1"	52		64	T-RI M36x2-R1"	17503011 A
	R 1"1/4	57		55	T-RI M36x2-R1"1/4	17503111 A
M 42X2	R 3/4"	32	20	50	T-RI M42x2-R3/4"	17503211 B
	R 1"	52		50	T-RI M42x2-R1"	17503311 A
	R 1"1/4	57		55	T-RI M42x2-R1"1/4	17503411 A
M 48X2	R 1"	36	22	55	T-RI M48x2-R1"	17503511 B
	R 1"1/4	60		55	T-RI M48x2-R1"1/4	17503611 A
	R 1"1/2	60		60	T-RI M48x2-R1"1/2	17503711 A

Istruzione di montaggio

1. Oleare i filetti d'estremità e le 2 O-ring.
2. Infilare la vite inferiore nel corpo del raccordo ed avvitare a mano.
3. Orientare il lato collegamento tubo e serrare la vite con la coppia di serraggio prescritto (vedere generalità, controbilanciando il corpo del raccordo)
4. Montare il tubo, controbilanciando il corpo del raccordo.
5. Mettere il tappo e serrare con la coppia prescritta (mass. _ giro).
6. Si può smontare e rimontare il raccordo senza limitazioni.
Verificare lo stato degli anelli torici e sostituire se necessario.

Attenzione : Un montaggio non conforme (lubrificazione o danneggiamento dell'O-ring superiore) riduce la pressione nominale e la durata della guarnizione con rischio di perdite.

Assembly instructions

1. Oil the threads and the 2 O-ring.
2. Insert the bolt into the banjo and tighten by hand.
3. Set the tube connection to the desired direction and tighten the bolt with the recommended tightening torque (see Technical notes) holding the banjo firmly by means of a spanner.
4. Fix the tube holding the banjo firmly by means of a spanner.
5. Set the blanking plug and tighten with the recommended tightening torque (max. _ of turn) holding the body of the coupling firmly by means of a spanner.
6. Repeated reassembly is possible. Check seals for possible damage and replace if necessary.

Attention : Different assembly (lubrication or damaging of the O-rings) reduces the nominal pressure rating and the life of the coupling, causing leakages.