

How to order TAA couplings

To enable the customer to choose his exact requirements, in the catalogue, the body can only be found, which is the base of the coupling.

When ordering, the exact coupling required by the customer can be obtained by altering the last digit of the coupling body number.

- 1) Select the body coupling required from the catalogue (XXX XXX X1 or XXX XXX X8).
- 2) Complete the coupling required by changing the last digit. This enables the customer to buy only and whatever he may require.

XXX XXX X1

A) Body of the coupling as shown in the catalog

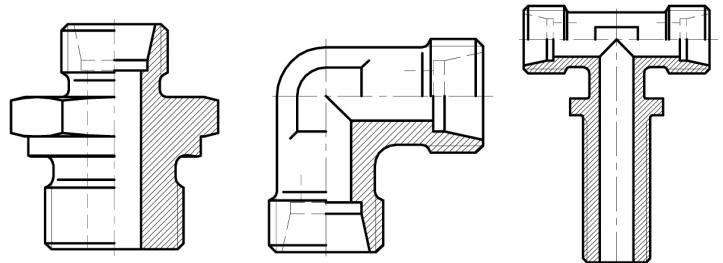

XXX XXX X2

B) Body of the coupling with lock nut

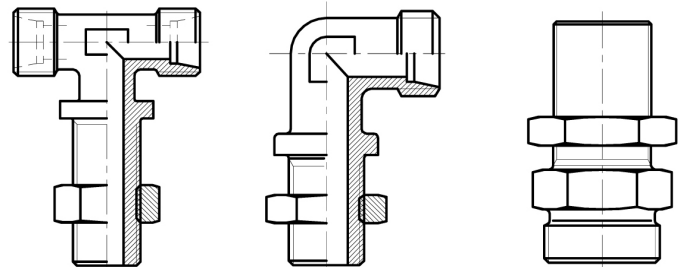

XXX XXX 3X

C) Stud thread only on coupling with 60° seating.

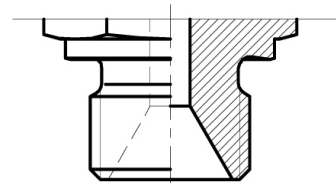

XXX XXX X0

D) Body of the coupling (as part A) complete with nut and olive for steel tube connection (Hydraulics)

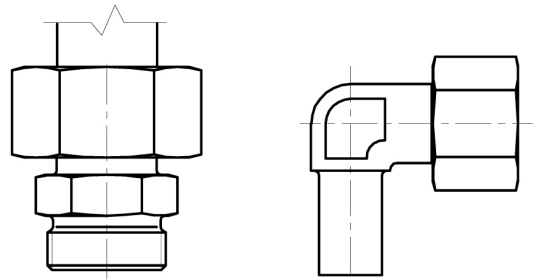

XXX XXX X7

E) Body of the coupling (as part A) complete with steel nut and brass olive for plastic tube connections (truck air brake system).

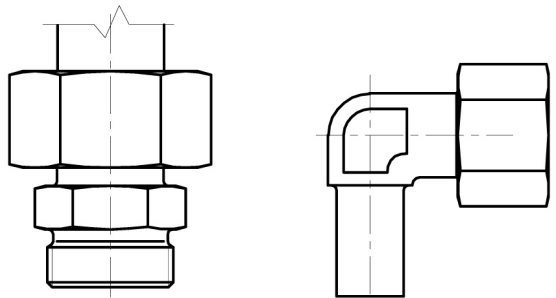

XXX XXX X3

F) Body of the coupling preassembled (as part E) complete with nut and olive for hydraulic tube connection.

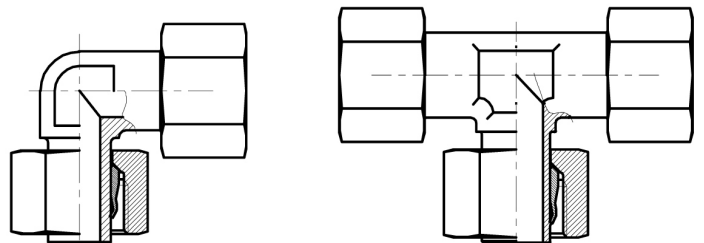

XXX XXX X8

G) Body of the coupling (as part A) preassembled on the standpipe.

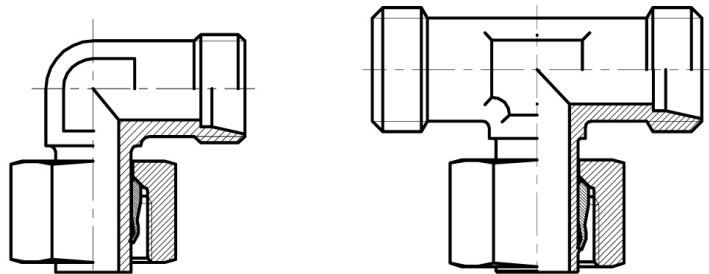

XXX XXX X6

H) Body of the coupling preassembled (as part E) complete with steel nut and brass olive for plastic tubes.

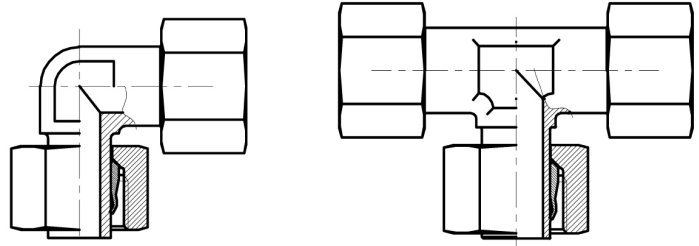

XXX XXX X9

I) Coupling completed with lock nut and O-Ring + ring for steel tube connection

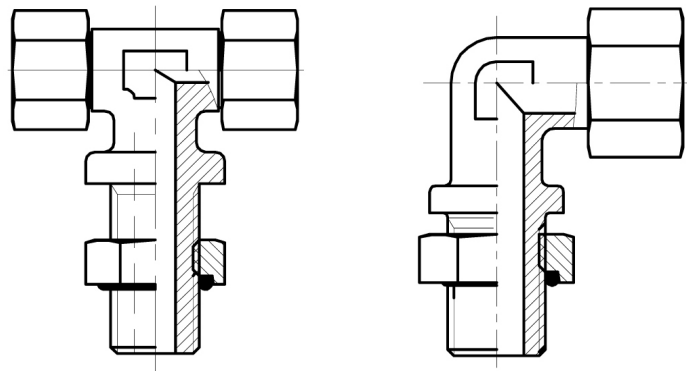

006 XXX X-

L) Camping rings for plastic tube connection to be ordered separately. Better work mod. 2

1

2

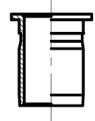
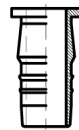

XXX XXXX 97

M) Coupling complete with lock nut and O-Ring; nut +ring for plastic tube connection

